

Project Name: \_\_\_\_\_ Contractor Name: \_\_\_\_\_

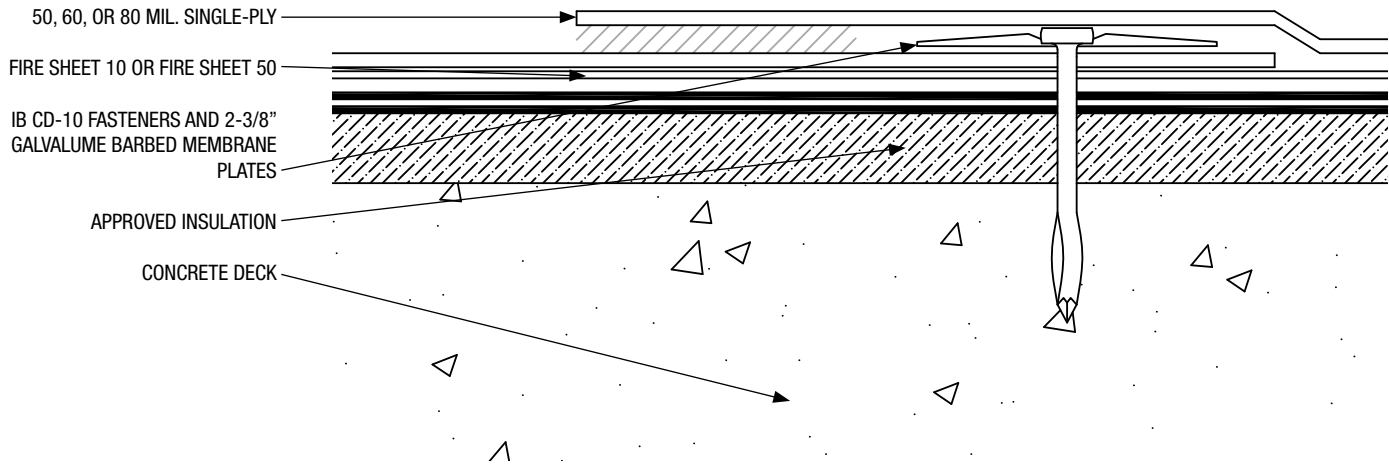

50  
  60  
  80  
 **MA-1FS-CRC (Concrete) FastSpec™**

**Concrete Deck – Recover – Fire Rated, Mechanically Attached Insulation / Membrane**

Fire Rating*	Deck Type	Separator Sheet (Over Existing Roof)		50, 60, or 80 mil. Single-Ply		Max. Design Pressure**
		Type	Attachment	Fasteners	Attachment	
<input type="checkbox"/> 1-1/2:12" Maintains Existing Fire Rating	Min. 2500 psi Concrete	Fire Sheet 10 or Fire Sheet 50	Max. 72-in. o.c. in min. 2-in. side laps spaced max. 46 in. apart with IB CD-10 Fasteners and 3" Galvalume Insulation Plates	IB CD-10 Fasteners and 2-3/8" Galvalume Barbed Membrane Plates	Max. 12-in. o.c. in min. 5-in. side laps spaced max. 67 in. apart. Outside of seam sealed with min. 1.5 in heat weld.	-45.0 psf (1) (FM-I-90)
<input type="checkbox"/> 1-1/2:12" Maintains Existing Fire Rating	Min. 2500 psi Concrete	Fire Sheet 10 or Fire Sheet 50	Max. 72-in. o.c. in min. 2-in. side laps spaced max. 46 in. apart with IB CD-10 Fasteners and 3" Galvalume Insulation Plates	IB CD-10 Fasteners and 2-3/8" Galvalume Barbed Membrane Plates	Max. 6-in. o.c. in min. 5-in. side laps spaced max. 67 in. apart. Outside of seam sealed with min. 1.5 in heat weld.	-60.0 psf (1) (FM-I-120)

The above assemblies and the attachments were tested and approved for use in the field of the roof. It is the designer of record and/or the roofing contractor's responsibility to determine the pressures for all three zones of the roof (field, perimeter, and corners per ASCE-7 05 and the building code) and through extrapolation, the lap spacing for the perimeter and corners zones. Contact IB Should you need assistance. The roofing system must be installed in strict accordance with the current 'IB Roof Systems Specifications Manual and Details', the project specifications, the building code, and good roofing practices by an authorized IB Applicator. Deviations from these requirements, not approved in writing by IB Roof Systems and the Authority Having Jurisdiction are not covered by any or implied IB Roof Systems Warranty.

\* Existing Roof: SBS or APP modified, or oxidized asphalt smooth coated, mineral surfaced, or gravel surfaced fire rated roofing system.

\*\* Minimum pull values on concrete deck (per ANSI/SPRI FX 1-05): 800 lbs. (1) Does not constitute an FM system. For reference only.

<b>Solar Reflectance (White)</b>	Initial: 0.87	3-Year Weathered: 0.74
<b>Thermal Emittance</b>	Initial: 0.88	3-Year Weathered: 0.90

**Available Warranties**

<input type="checkbox"/>	<b>50 Mil Membrane</b>	<input type="checkbox"/> CG	15-Year 'Material Only', Material and Labor, or No Dollar Limit (NDL). Additional warranties also available.
<input type="checkbox"/>	<b>60 Mil Membrane</b>	<input type="checkbox"/> TR	20-Year 'Material Only', Material and Labor, or No Dollar Limit (NDL). Additional warranties also available.
<input type="checkbox"/>	<b>80 Mil Membrane</b>	<input type="checkbox"/> CG	25-Year 'Material Only', Material and Labor, or No Dollar Limit (NDL). Additional warranties also available.

**IB Roof Systems are listed with the following agencies:**
