

Project Name: _____ Contractor Name: _____

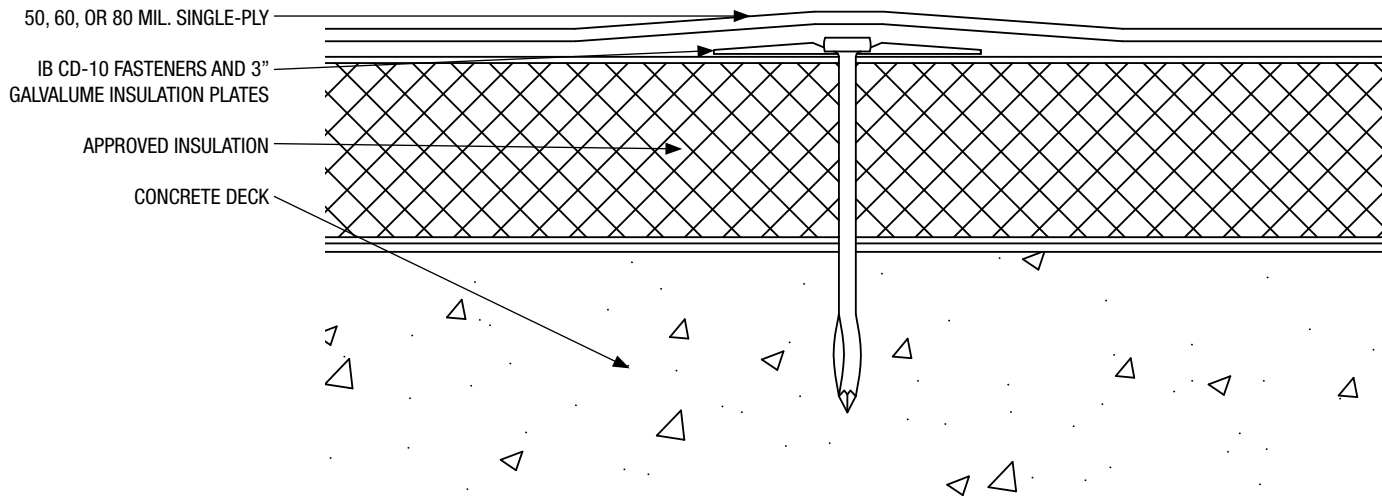

50 60 80 FA-RI-C (Concrete) FastSpec™

Concrete Deck – New Construction or Re-Roof (Tear-Off) – Fire Rated, Mechanically Attached Insulation and Bonded Membrane							
Fire Rating		Deck Type	Insulation			50, 60, or 80 mil. Single-Ply	Max. Design Pressure**
			Type	Attachment	Fasteners	Attachment	
<input type="checkbox"/>	2:12" Class 'A'	Min. 2500 psi Concrete	One or more layers of Polyisocyanurate	Attached with 1 fastener per 3.2 ft ² (5 per 4 x 4) (10 per 4 x 8)	IB CD-10 Fasteners and 3" Galvalume Insulation Plates	Vertibond or Waterborne Adhesive applied at the nominal rate of 1 to 1.5 gallons per 100 sq. ft.	-30.0 psf ⁽¹⁾ (FM-I-60)
<input type="checkbox"/>	2:12" Class 'A'	Min. 2500 psi Concrete	One or more layers of Polyisocyanurate	Attached with 1 fastener per 3.2 ft ² (5 per 4 x 4) (10 per 4 x 8)	IB CD-10 Fasteners and 3" Galvalume Insulation Plates	Vertibond or Waterborne Adhesive applied at the nominal rate of 1 to 1.5 gallons per 100 sq. ft.	-45.0 psf ⁽¹⁾ (FM-I-90)
<p><i>The above assemblies and the attachments were tested and approved for use in the field of the roof. It is the designer of record and/or the roofing contractor's responsibility to determine the pressures for all three zones of the roof (field, perimeter, and corners per ASCE-7 05 and the building code) and through extrapolation, the lap spacing for the perimeter and corners zones. Contact IB Should you need assistance. The roofing system must be installed in strict accordance with the current 'IB Roof Systems Specifications Manual and Details', the project specifications, the building code, and good roofing practices by an authorized IB Applicator. Deviations from these requirements, not approved in writing by IB Roof Systems and the Authority Having Jurisdiction are not covered by any or implied IB Roof Systems Warranty.</i></p> <p>Approved Insulations: IB ISO, II, III, and IV, R-Max Multi-Max, Hunter, Atlas ACFoam II, III, IV, JM "NRG", Firestone, GAFTemp Polyisocyanurate Tapered or Flat Stock.</p> <p>** Minimum pull values on concrete deck (per ANSI/SPRI FX-1): 800 lbs. (1) Does not constitute an FM system. For reference only.</p>							
Solar Reflectance (White)				Initial: 0.87		3-Year Weathered: 0.74	
Thermal Emittance				Initial: 0.88		3-Year Weathered: 0.90	
Available Warranties							
<input type="checkbox"/>	50 Mil Membrane	<input type="checkbox"/> CG	15-Year 'Material Only', Material and Labor, or No Dollar Limit (NDL). Additional warranties also available.				
<input type="checkbox"/>	60 Mil Membrane	<input type="checkbox"/> TR	20-Year 'Material Only', Material and Labor, or No Dollar Limit (NDL). Additional warranties also available.				
<input type="checkbox"/>	80 Mil Membrane	<input type="checkbox"/> CG	25-Year 'Material Only', Material and Labor, or No Dollar Limit (NDL). Additional warranties also available.				
IB Roof Systems are listed with the following agencies:							
 MIAMI-DADE COUNTY	 CRRC COOL ROOF RATING COUNCIL MEMBER			 ENERGY STAR PARTNER			<i>Title 24</i>