

MEMBRANE VENT OVER EXISTING ROOF

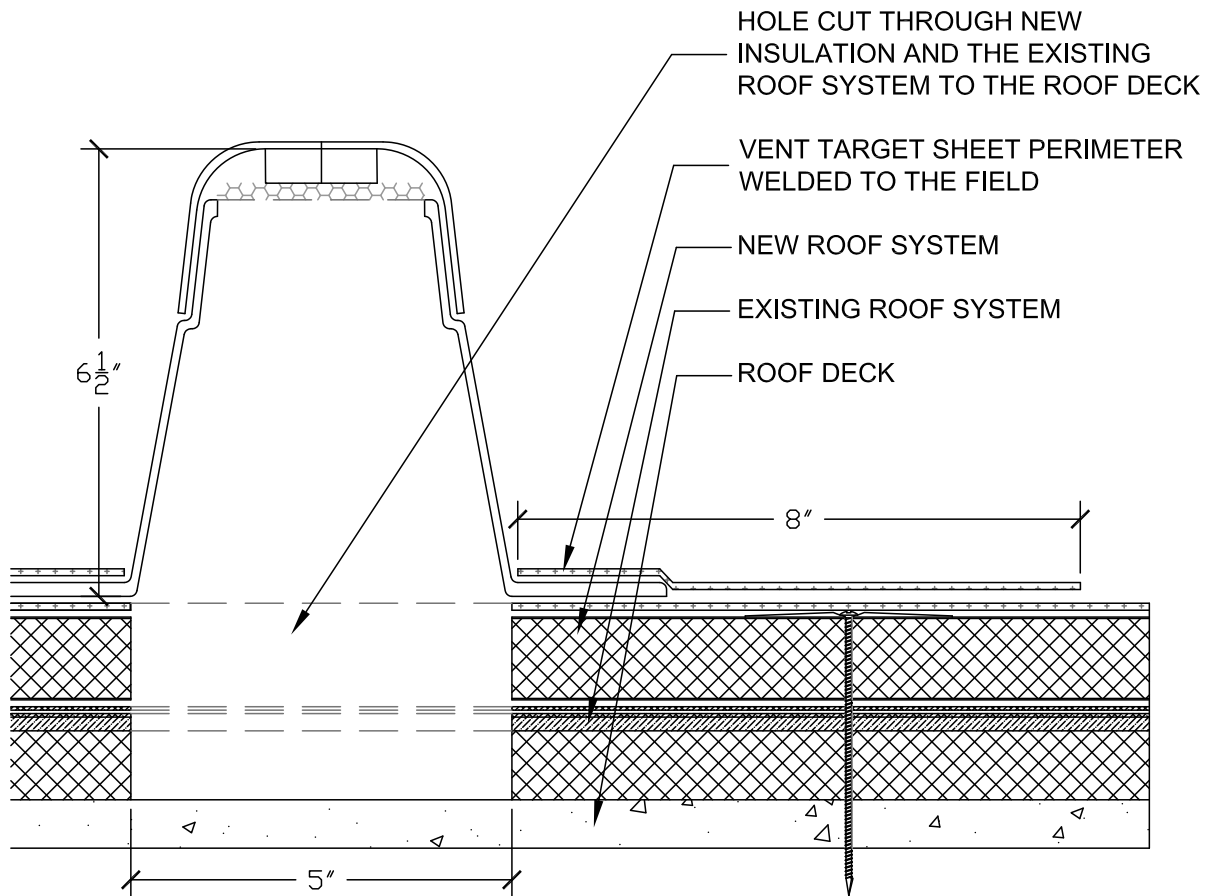

NOTES:

- ONE WAY VENTS ARE TO BE USED TO VENT EXISTING, INSULATED ROOFING SYSTEMS THAT ARE OVER-LAID WITH AN IB ROOFING SYSTEM, OR NEW LIGHT-WEIGHT CONCRETE ROOF DECKS. INSTALL AT A SPACING OF 1 VENT PER 100 SQ. FEET.

PROJECT NAME:

TITLE:

MP-5 MEMBRANE VENT OVER EXISTING ROOF

** Click here to link to the AutoCAD™ drawing*

SCALE: NTS

APPROVED BY:

DRAWN BY: A.SCHWAB

PLOT DATE: 11-08
REV: AS 11-08