

ROOF CURB/ HATCH DETAIL

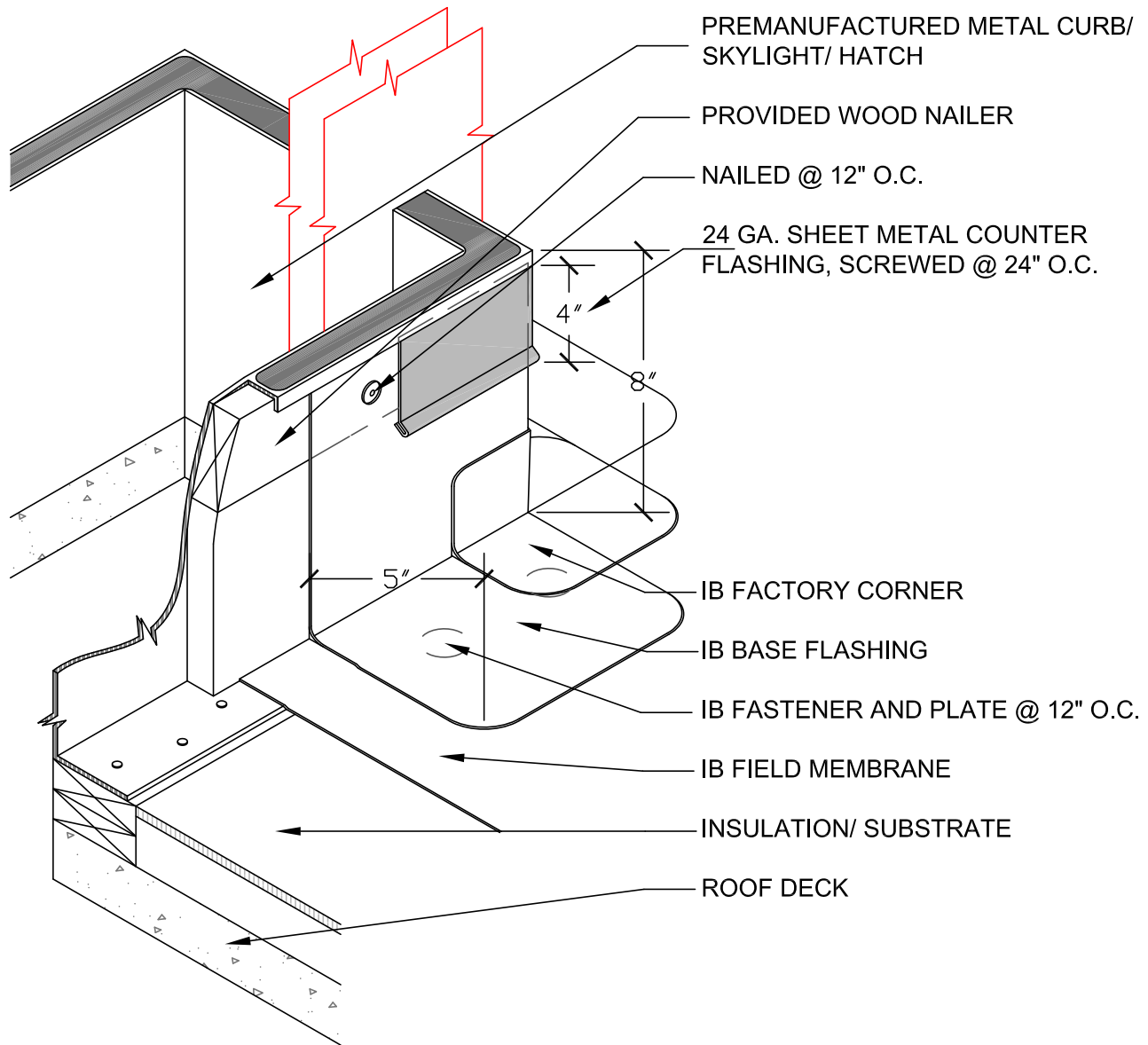

NOTES:

1. FILL SUBSTRATE FOR THE CURBS SHOULD BE ONE OF THE FOLLOWING: PERLITE, POLYISOCYANURATE, GYPSUM BASED BOARD (LIKE DENS DECK™ OR SECUROCK™), EXTERIOR GRADE PLY WOOD OR ORIENTED STRAND BOARD. USE OF INSULATION ADHESIVE LIKE INSTA-STIK™ IS PREFERRED TO PREVENT FASTENERS FROM PENETRATING AND CREATING A SAFETY HAZARD TO ROOF HATCH USERS.
2. COUNTER-FLASHING CAN BE OMITTED FROM ROOF HATCHES THAT HAVE DESIGNED INTO THE HATCH, A CRIMPING SECUREMENT SYSTEM (USE OF BACKER-ROD AND CRIMPED PUNCHES)

PROJECT NAME:

TITLE:

MB-18 ROOF CURB/ HATCH DETAIL

** Click here to link to the AutoCAD™ drawing*

SCALE: NTS

APPROVED BY:

DRAWN BY: A.SCHWAB

PLOT DATE: 11-08
REV: AS 11-08