

**SINGLE LAYER OF FIRE SHEET**

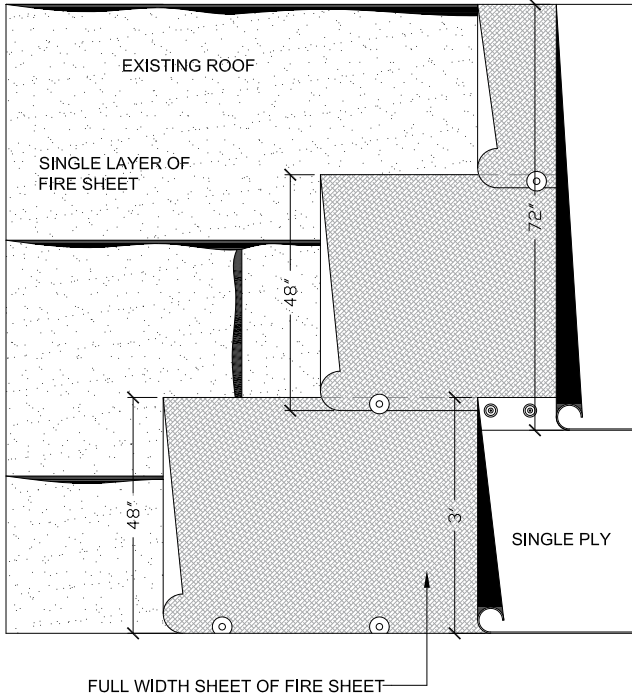

FIRE SHEET	SLOPE	FIRE RATING	LAYERS
Fire Sheet 10 or Fire Sheet 50	0-3/4"	Recover: Main- tains existing Fire Rating	1
Fire Sheet 10 or Fire Sheet 50	0-3/4"	New/ Re-Roofs Class 'B'	1

**NOTES:**

1. Fire Sheet is typically used over combustible roof decks (I.E. plywood/OSB/wood plank) in combination with Single Ply to achieve either a Class 'A' or 'B' Fire Rating. \*See graph for requirements.
2. Fire Ratings for IB Roof Systems can be found on the Underwriters Laboratory (UL) website:www.ul.com
3. Fire Sheets are to be attached to the roof deck with #12,#14, #15, or XHD screws and insulation plates. Fastener spacing may vary depending on AHJ.

**DOUBLE LAYER OF FIRE SHEET**

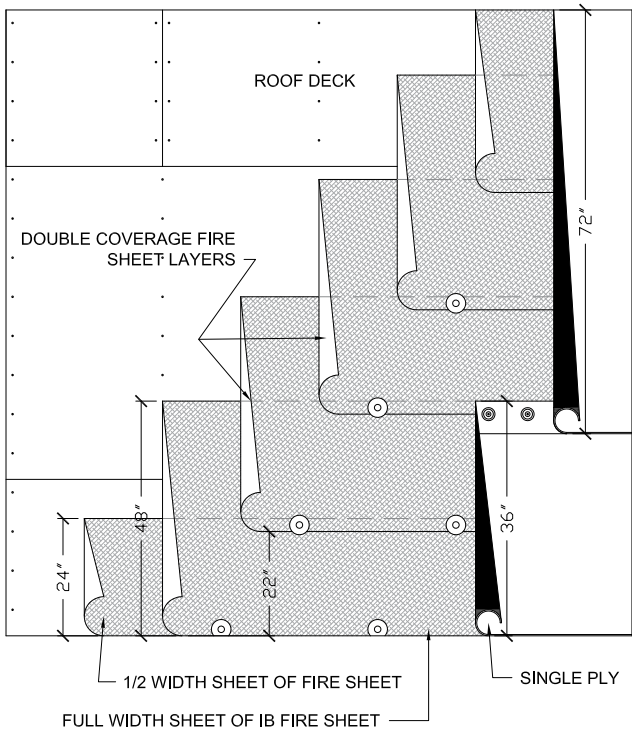

FIRE SHEET	SLOPE	FIRE RATING	LAYERS
Fire Sheet 10	0-3/4"	Class 'A'	2
Fire Sheet 50	0-3/4"	Class 'A'	2

**NOTES:**

1. Fire Sheet is typically used over combustible roof decks (I.E. plywood/OSB/wood plank) in combination with Single Ply to achieve either a Class 'A' or 'B' Fire Rating. \*See graph for requirements.
2. Fire Ratings for IB Roof Systems can be found on the Underwriters Laboratory (UL) website:www.ul.com
3. Fire Sheets are to be attached to the roof deck with #12,#14, #15, or XHD screws and insulation plates. Fastener spacing may vary depending on AHJ.

PROJECT NAME:

TITLE:

**MA-8 FIRE SHEETS**

*\* Click here to link to the AutoCAD™ drawing*

SCALE: NTS

APPROVED BY:

DRAWN BY: A.SCHWAB

PLOT DATE:11-08  
REV: AS 11-08