

RAISED FASCIA EDGE

PERIMETER METAL, FASTENED
WITH GROMMET SCREWS AND
NEOPRENE WASHES AT 12"
O.C.

SHOWN WITH OPTIONAL
METAL RETURN

22 GA. CONTINUOUS CLEAT,
ATTACHED INTO BLOCKING AT
12" O.C.

BASE FLASHING STRIP RAN UP
AND DOWN FACE OF RAISED
FASCIA AND PERIMETER
WELDED TO THE FIELD

FIELD MEMBRANE

SCREWS AND MEMBRANE
PLATES AT 12" O.C.

INSULATION/ SUBSTRATE

ROOF DECK

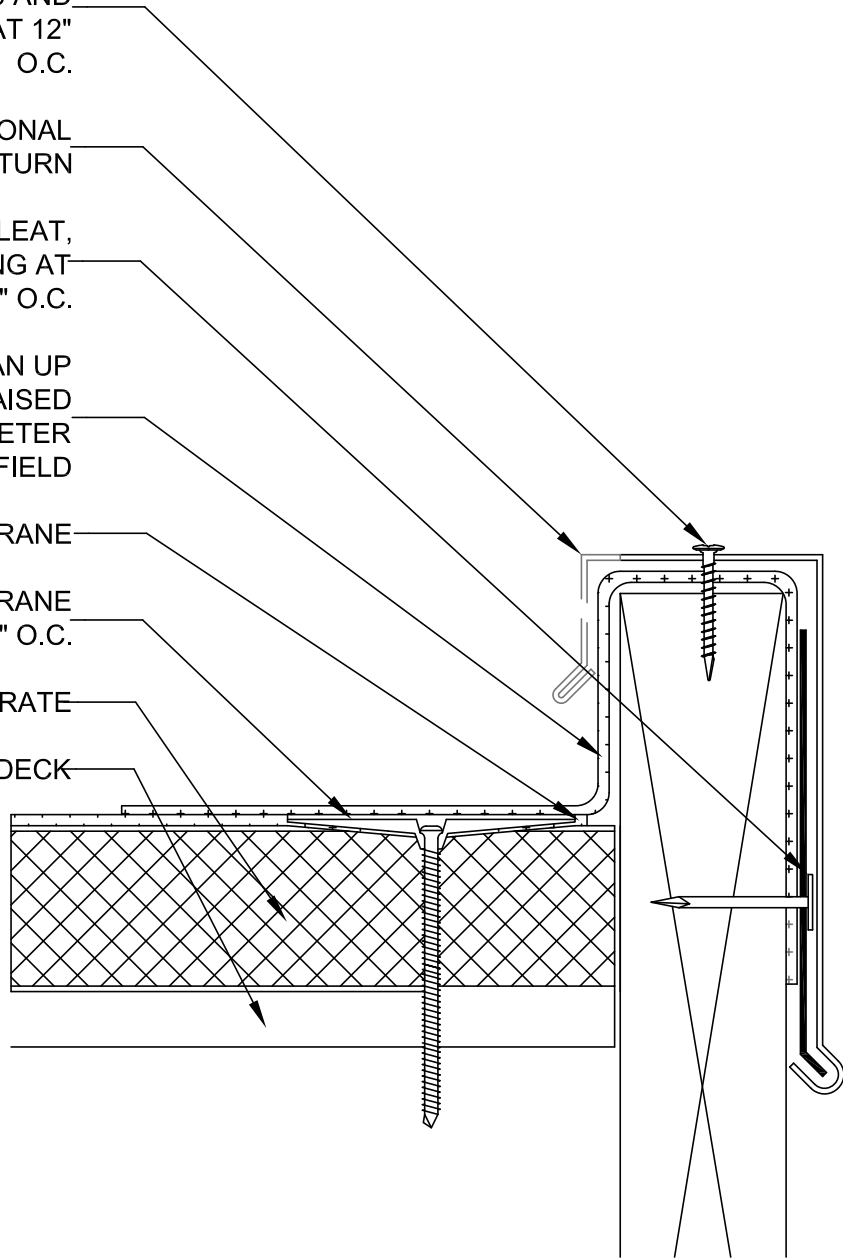

PROJECT NAME:

TITLE:

FE-10 RAISED FASCIA EDGE

** Click here to link to the AutoCAD™ drawing*

SCALE: NTS

APPROVED BY:

DRAWN BY: A.SCHWAB

PLOT DATE: 11-08
REV: AS 11-08